



NORWEST

MANUFACTURING

71 SOUTH 215 WEST-RUPERT, ID- PHONE: (208) 436-1770 - FAX: (208) 436-1776

SECTION 300

BLADES

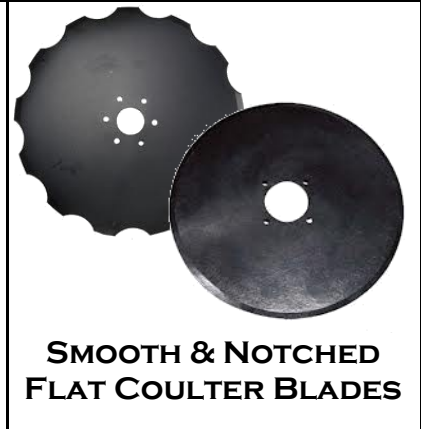
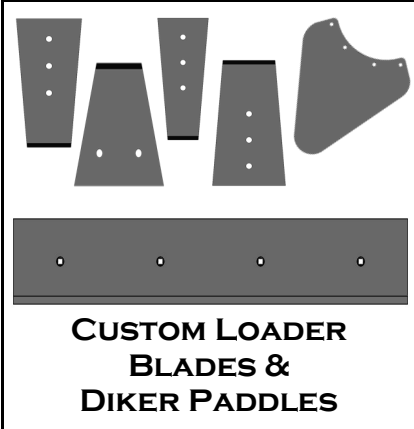
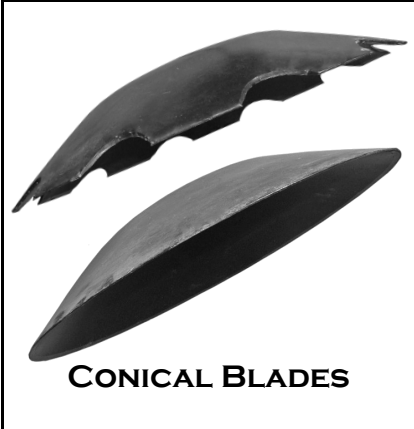



NORWEST

MANUFACTURING

71 SOUTH 215 WEST-RUPERT, ID- PHONE: (208) 436-1770 - FAX: (208) 436-1776



DIRECTIONAL WAVY COULTER BLADES



Blades for Minimal Till, Strip Till, and Ridge Till Applications.

Available in 18", 20", 22", & 24"



PART #	BLADE DIAMETER	BLADE THICKNESS			APPROX. WEIGHT OF BLADE (lbs.)	WAVE MEASUREMENT (A)
		MM	GAUGE	DECIMAL		
DV1860-00	18"	6.00MM	4	.236	16.64	1-1/16"
DV2060-00	20"	6.00MM	4	.236	19.91	1-1/8"
DV2260-00	22"	6.00MM	4	.236	26.34	1-1/16"
DV2460-00	24"	6.00MM	4	.236	29.00	1-1/8"

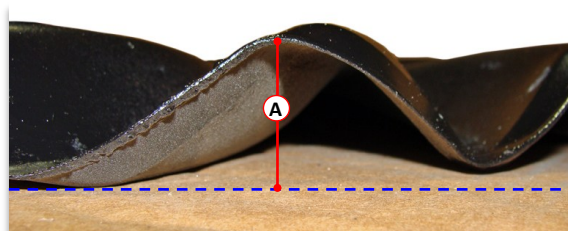



NORWEST

MANUFACTURING

71 SOUTH 215 WEST-RUPERT, ID- PHONE: (208) 436-1770 - FAX: (208) 436-1776



WEAR-TUFF™

Norwest Manufacturing is now offering our customers the option of adding **Wear-Tuff™** protective coating from **LundTek** to ANY blade.

Why add a Protective Coat?

- ◆ Adding **Wear-Tuff™** will dramatically improve the service life of components operating in highly abrasive environments.
- ◆ Parts can last up to six times longer before needing replacement. This helps reduce costs as parts will be changed less frequently.
- ◆ **Wear-Tuff™** promotes more consistent wear of the part so it will maintain its ideal shape longer.
- ◆ Smooth finish significantly reduces drag.
- ◆ Because the coated side will wear slower than the non-coated side, the part will actually sharpen itself as it works.

Coultter Blades

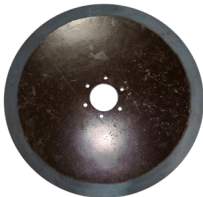

Wavy Blades



Smooth Blades



Directional Wavy
Blades



Notched Blades



Now Available on All Blades!

www.norwest-mfg.com

Blades 300-3

***Wear-Tuff™ protective coating not applied at Norwest Manufacturing. Please allow sufficient time when placing blade orders with Wear-Tuff™. Call Norwest Mfg. for more information.**



NORWEST

MANUFACTURING



71 SOUTH 215 WEST-RUPERT, ID- PHONE: (208) 436-1770 - FAX: (208) 436-1776

O.E.M. DISC BLADE CENTER HOLE LIST

O.E.M. DISC MODEL NUMBER	AXLE SIZE	O.E.M. DISC MODEL NUMBER	AXLE SIZE
<u>ALLIS CHALMERS</u> 2100 2300	1-1/2" SQUARE 1-1/2" SQUARE	<u>DUNHAM-LEHR</u> GC 34	1-1/8" SQUARE 1-1/2" ROUND
<u>AMCO</u> WOD, WTD WOE WOF, WOJ WTF, WTJ F-15 F-15B 48 85 148 185 248 258	1-1/8" SQUARE 1-3/8" ROUND 1-1/2" SQUARE 1-1/2" SQUARE 1-1/2" SQUARE 1-1/2" SQUARE 1-1/2" SQUARE 1-1/2" SQUARE 1-1/2" SQUARE 1-1/2" SQUARE 1-1/2" SQUARE 1-1/2" SQUARE 1-1/2" SQUARE	<u>FORD</u> 201 202 204 219 220 221 222 223 236 240 241 243	1" ROUND 1" ROUND 1" ROUND 1-1/2" SQUARE 1-1/8" SQUARE 15/16" ROUND 1-1/8" SQUARE 1-1/8" SQUARE 1-1/2" SQUARE 1-1/8" SQUARE 1-1/8" SQUARE 1-1/2" ROUND
<u>ATHENS</u> 48 62 116 126 131	1" SQUARE 1-1/8" SQUARE 1-1/2" SQUARE 1-1/2" SQUARE 1-1/2" SQUARE	<u>HESSTON</u> 2410 2440 2420	1-3/4" ROUND 1-1/8" SQUARE 1-1/8" SQUARE
<u>BLANTON</u> 4500 B900 B1000 3000H	1-1/2" SQUARE 1-1/8" SQUARE 1-1/8" SQUARE 1-1/2" SQUARE	<u>INTNTL. HARVESTER</u> 122 132 350 370 470 475 480 485 490 500 501 596 610 630 770 780	1-1/8" SQUARE 1-1/8" SQUARE 1-1/8" SQUARE 1-1/8" SQUARE 1-1/8" SQUARE 1-1/8" SQUARE 1-1/8" SQUARE 1-1/8" SQUARE 1-1/8" SQUARE 1-1/2" SQUARE 1-1/2" SQUARE 1-1/2" SQUARE 1-1/2" SQUARE 1-1/2" SQUARE 1-1/2" SQUARE 1-3/4" SQUARE
<u>BLANTON</u> KWIK-SET 208 BW 209 TRU-CUT	1-1/8" SQUARE 1-1/2" ROUND 1-1/8" SQUARE 7/8" SQUARE		
<u>BRUSH HOG</u> 245 246 1440 1445 1450 145 146 REG 146 HD 1422 1424 1432 1436 1437 1438 1439 1444 ROLLING BEDDER	1-1/4" OR 1-1/2" SQUARE 2-1/4" ROUND 1-1/8" SQUARE 1-1/8" OR 1-1/4" SQUARE 1-1/8" OR 1-1/4" SQUARE 1-1/4" SQUARE 1-1/4" SQUARE 1-1/2" SQUARE 1" OR 1-1/8" SQUARE 1-1/8" SQUARE 1-1/8" SQUARE 1-1/8" SQUARE 1-1/8" OR 1-1/2" SQUARE 1-1/8" SQUARE 1-1/8" SQUARE 1-1/8" SQUARE 1-1/8" SQUARE 1-1/8" SQUARE 1-1/8" SQUARE	<u>JOHN DEERE</u> 105 115 215 225 235 425 1630 100 110 200 & 210 SERIES 220 230 (CONE DISC) 310	1" ROUND 1-1/8" ROUND 1-1/2" ROUND 1-1/2" ROUND 1-1/2" ROUND 1-1/2" ROUND 1-1/2" SQUARE 1-1/8" SQUARE 1-1/8" SQUARE 1-1/8" SQUARE 1-1/8" SQUARE 1-1/8" SQUARE 1-1/8" SQUARE 1-1/8" SQUARE



NORWEST

MANUFACTURING

71 SOUTH 215 WEST-RUPERT, ID- PHONE: (208) 436-1770 - FAX: (208) 436-1776

O.E.M. DISC BLADE CENTER HOLE LIST

O.E.M. DISC MODEL NUMBER	AXLE SIZE	O.E.M. DISC MODEL NUMBER	AXLE SIZE
<u>JOHN DEERE</u> 525 1630 1635 1640 2620 (CONE DISC) 2621 2650 2651 2700 BWA BWF	1-1/4" SQUARE 1-1/2" ROUND 1-1/2" SQUARE 1-1/2" SQUARE 1-1/2" SQUARE 1-1/2" SQUARE 1-3/4" SQUARE 1-3/4" SQUARE 2-1/4" SQUARE 1-1/4" SQUARE 1-1/4" SQUARE	<u>LONG</u> 953 1080 1087-88-89	7/8" SQUARE 1-1/2" SQUARE 1-1/2" SQUARE
<u>KELLO BILT</u> N/A	1-5/8" ROUND	<u>MASSEY</u> MF820 MF620 MF520 MF270 MF21 MF25 MF30 MF720 MF39 MF40 MF52 MF72 MF120 MF220 MF223 MF213	1-1/4" SQUARE 1-1/4" SQUARE 1-1/4" SQUARE 1-1/2" SQUARE 1" SQUARE 1" ROUND 1-1/2" SQUARE 1-1/2" SQUARE 1" ROUND 1-1/2" SQUARE 1-1/8" ROUND 1-1/8" ROUND 1-1/8" SQUARE 1-1/8" SQUARE 1-1/8" SQUARE 1-1/8" SQUARE
<u>KENT</u> 6112D 6118D 6323D 6327D 7333D 6540D 7550D	1-1/2" ROUND 1-1/2" ROUND 1-1/2" ROUND 1-1/2" ROUND 1-1/2" ROUND 1-1/2" ROUND 1-1/2" ROUND		
<u>KEWANEE</u> 800 1000	1-1/8" SQUARE 1-1/8" SQUARE	<u>MILLER</u> SERIES I SERIES II	1-3/4" ROUND 1-3/4" ROUND
<u>KRUASE</u> 1952-1956-1960-1970 1968-1969-1979 1965-1966-1976 1480 SERIES 1480 SERIES 1900 SERIES 1950 SERIES 2100 SERIES 2200 SERIES 2400 SERIES 2400 SERIES 2700 SERIES 3100 SERIES 3200 SERIES 1498 & 1499 1465-1470 1580 1740-1769 1912-1915-1918 1901-1904-1907 1922-1925-1928 1921-1924-1927 1959-1963-1973	1-1/2" ROUND 1-1/2" ROUND 1-1/2" ROUND 1-1/2" ROUND 1-3/4" ROUND 1-1/2" ROUND 1-1/2" ROUND 1-1/2" ROUND 1-1/2" ROUND 1-1/2" ROUND 1-3/4" ROUND 2-1/2" ROUND 1-1/2" ROUND 1-3/4" ROUND 1-1/2" ROUND 1-3/4" ROUND 1-1/2" ROUND 1-1/2" ROUND 1-1/2" ROUND 1-1/2" ROUND 1-1/2" ROUND 1-1/2" ROUND	<u>NEW HOLLAND</u> OD100 OD200 OD300 TD100 TD200	1-3/4" ROUND 1-3/4" ROUND 2" ROUND 1-3/4" ROUND 1-3/4" ROUND
		<u>RHINO</u> 127/167 131 137/187 177 FLEX 90 FLEX 90B	1-1/2" SQUARE 1-1/2" SQUARE 1-1/2" SQUARE 1-1/2" SQUARE 1-1/8" SQUARE 1-1/4" SQUARE



NORWEST

MANUFACTURING



71 SOUTH 215 WEST-RUPERT, ID- PHONE: (208) 436-1770 - FAX: (208) 436-1776

O.E.M. DISC BLADE CENTER HOLE LIST

O.E.M. DISC MODEL NUMBER	AXLE SIZE	O.E.M. DISC MODEL NUMBER	AXLE SIZE
<u>SUNFLOWER</u> 1210 1211 1230 1231 1320 & 1330 1321 1331 1430 & 1440 1431 1441 1541 4211 6010 6030	1-1/2" ROUND 1-3/4" ROUND 1-1/2" ROUND 1-3/4" ROUND 1-3/4" ROUND 1-3/4" ROUND 1-3/4" ROUND 1-3/4" ROUND 1-3/4" ROUND 1-3/4" ROUND 1-3/4" ROUND 1-3/4" ROUND 1-3/4" ROUND 1-3/4" ROUND 1-3/4" ROUND 1-3/4" ROUND 1-3/4" ROUND 1-3/4" ROUND 1-3/4" ROUND 1-3/4" ROUND	<u>WHITE</u> 250 251 252 253 254 255 256 263 264 265 271 272 273/274 281	1-1/8" SQUARE 1-1/8" SQUARE 1-1/8" SQUARE 1-1/8" SQUARE 1-1/8" SQUARE 1-1/8" SQUARE 1-1/8" SQUARE 1-1/8" SQUARE 1-1/8" SQUARE 1-1/8" SQUARE 1-1/8" SQUARE 1-1/8" SQUARE 1-1/8" SQUARE 1-1/8" SQUARE 1-1/8" SQUARE 1-1/8" SQUARE 1-1/8" SQUARE 1-1/8" SQUARE 1-1/8" SQUARE 1-1/2" ROUND 1-1/2" SQUARE
<u>SCHAFER</u> H-3 H-4 355 555	1-3/4" ROUND 1-3/4" ROUND 1-3/4" ROUND 1-3/4" ROUND	<u>WISHEK</u> 612N 812N 842N 862N 932N Y-2000 714NT 742NT 814NT 816NT 842NT 862NT	1-15/16" ROUND 1-15/16" ROUND 1-15/16" ROUND 1-15/16" ROUND 2-3/4" ROUND 1-15/16" ROUND 1-15/16" ROUND 1-15/16" ROUND 1-15/16" ROUND 1-15/16" ROUND 1-15/16" ROUND 1-15/16" ROUND 1-15/16" ROUND
<u>TAYLOR WAY</u> 200251-200268 200108-200118 200023 200024 200196-200199 2000051-2000068 200284-200297 200310-200315 2001 SERIES 200011 200013 200035 200036 200037 200048 200049 2000165 2000166 2000167	1-1/2" SQUARE 1-1/8" SQUARE 1-1/8" SQUARE 1-1/8" SQUARE 1-1/8" SQUARE 1-1/8" SQUARE 1-1/8" SQUARE 1-1/2" SQUARE 1-1/2" SQUARE 1-1/8" SQUARE 7/8" SQUARE 7/8" SQUARE 1-1/8" SQUARE 1-1/8" SQUARE 1-1/8" SQUARE 1-1/8" SQUARE 1-1/8" SQUARE 1-1/8" SQUARE 7/8" SQUARE 7/8" SQUARE 7/8" SQUARE		
<u>VASSAR</u> DISC EZY	1-1/8" SQUARE		



Smooth Concave Disc Blade

Norwest Part #

DS _____ -
 DST _____ -
 DSA _____ -
 DSX _____ -

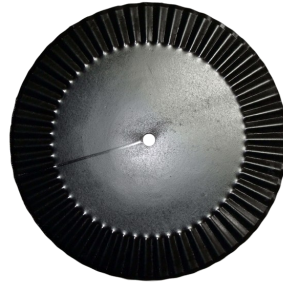

Fluted Coulter Blade

Norwest Part #

DSS _____ -
 DSST _____ -
 DSSA _____ -



Notched Concave Disc Blade

Norwest Part #

DN _____ -
 DNT _____ -
 DNA _____ -
 DNX _____ -



Notched Raised Flat Center Disc Blade

Norwest Part #

DNFF _____ -
 DNFFA _____ -

***Notched Raised Flat Center Disc Blade**

DNF _____ -
 DNFT _____ -
 DNFA _____ -



Smooth Flat Coulter Blade

Norwest Part #

DSR _____ -
 DSRT _____ -
 DSRA _____ -



***Smooth Flat Center Disc Blade**

Norwest Part #

DSFF _____ -
 DSFFA _____ -

Smooth Raised Flat Center Disc Blade

Norwest Part #

DSF _____ -
 DSFT _____ -
 DSFA _____ -



Notched Flat Coulter Blade

Norwest Part #

DNR _____ -
 DNRT _____ -
 DNRA _____ -



Directional Wavy Coulter Blade

Norwest Part #

DV _____ -



Wavy Coulter Blade

Norwest Part #

DSR _____ - W
 DSRT _____ - W
 DSRA _____ - W
 or
 DSW _____ - 08/13/25



Deep Cone (Conical) Disc Blade

Norwest Part #

DNC _____ -
 DNCT _____ -
 or
 DSC _____ -
 DSCT _____ -

EXAMPLE
DNR2460-00
 N = Notched; 24 = 24 Inches; 60 = 6mm Thick
DSX2480-00
 S = Smooth; 24 = 24 Inches; 80 = 8mm Thick

Disc Blade Thickness

4.5 mm = 3/16" Thick
 6 mm = 1/4" Thick
 8 mm = 5/16" Thick
 10 mm = 3/8" Thick



NORWEST

MANUFACTURING

71 SOUTH 215 WEST-RUPERT, ID- PHONE: (208) 436-1770 - FAX: (208) 436-1776



HOLE PATTERNS FOR MOST COMMON AXLES

SQUARE	ROUND	COMBO SQUARE/SQUARE	COMBO SQUARE/ROUND	GOBEL	HEXAGONAL
Norwest Single Hole Cut					
<i>Part #: SC-1SQH</i>			<i>Part #: SC-1RDH</i>		

- ◆ WHEN DETERMINING HOLE SIZE, BE SURE TO GET THE DIMENSIONS SHOWN ABOVE
 - ◆ KNOWING AXLE SIZE IS MOST CRITICAL
 - ◆ HOLES ARE CUT 1/16" LARGER THAN AXLE FOR AN EASY FIT

HOLE PATTERNS FOR MOST COMMON HUB PATTERNS

THREE (3) HOLE HUB PATTERN <i>SC-3H</i>	FOUR (4) HOLE HUB PATTERN <i>SC-4H</i>	FIVE (5) HOLE HUB PATTERN <i>SC-5H</i>	SIX HOLE HUB PATTERN <i>SC-6H</i>

SINGLE HOLE CUT

SELECT ONE



Axle size cannot be determined by threaded end of axle.

- AXLE SIZE _____
- HOLE SIZE _____

SQUARE

(Hole Size is 1/16" Larger than Axle Size)

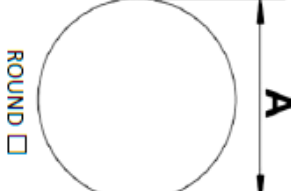

ROUND

(Hole Size is 1/16" Larger than Axle Size)

- AXLE SIZE _____
- HOLE SIZE _____

Axle size cannot be determined by threaded end of axle.

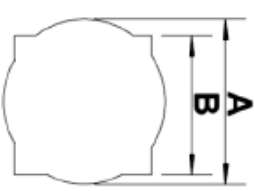

COMBO ROUND

(Hole Size is 1/16" Larger than Axle Size)

- A. AXLE SIZE _____
- A. HOLE SIZE _____

- B. AXLE SIZE _____

- B. HOLE SIZE _____

Axle size cannot be determined by threaded end of axle.



COMBO SQUARE

- A. AXLE SIZE _____
- A. HOLE SIZE _____

- B. AXLE SIZE _____
- B. HOLE SIZE _____

(Hole Size is 1/16" Larger than Axle Size)

Axle size cannot be determined by threaded end of axle.

DISC BLADE HOLE CUT PROOF

HUB PATTERN CUT - FOR FLAT COULTER BLADES & FLAT CENTER BLADES

SELECT ONE

COMMON AXLES: SQUARE - : 1-1/8" • 1-1/4" • 1-1/2" • 1-3/4" • 2"
 ROUND - : 1-5/8" • 1-3/4" • 2"

Holes to be cut into Concave Disc Blades are 1/16" LARGER than Axle Size.

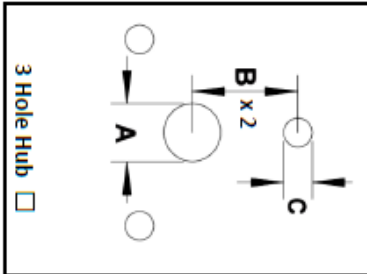

3 Hole Hub

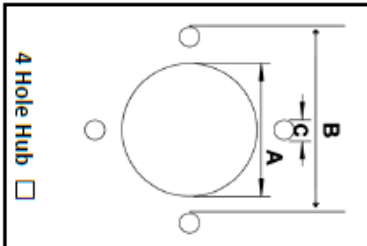

4 Hole Hub

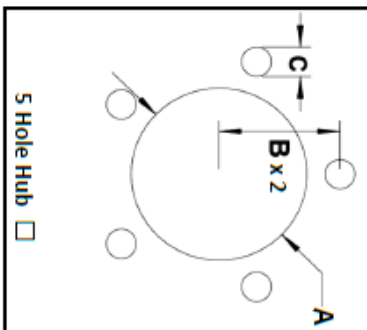

5 Hole Hub

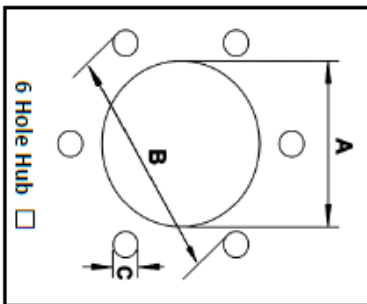

6 Hole Hub

PROVIDE MEASUREMENTS:

- (A) CENTER HOLE SIZE _____
- (B) BOLT HOLE CENTER TO CENTER _____
- (C) HOLE SIZE _____
- (D) BOLT SIZE _____

DRAW HOLE PATTERN IF NOT SHOWN ABOVE:

Blade Style: _____
 (Smooth, Notched, Coultter, Concave, Flat Center...)
 Blade Diameter: _____ (Inches)
 Blade Thickness: _____ (mm)
 Blade Quantity: _____



NORWEST

M A N U F A C T U R I N G

PHONE: (208) 436-1770 • FAX: (208) 436-1776

By Signing, you are stating that the blade order and the hole cut is correct. Your signature makes the order and it's payment, the responsibility of the Signee/Company.
 Signature: _____ DATE: _____



NORWEST

MANUFACTURING



71 SOUTH 215 WEST-RUPERT, ID- PHONE: (208) 436-1770 - FAX: (208) 436-1776

SMOOTH CONCAVE DISC BLADES

PART NUMBER	BLADE DIAMETER	THICKNESS			BLADE WEIGHT (LBS) (Approx.)
		mm	GAUGE	DECIMAL	
* DS1025	10"	2.50mm	N/A	.098	2.05
* DS1435	14"	3.50mm	10	.138	8.91
* DS1445	14"	4.50mm	7	.177	11.00
* DS1630	16"	3.00mm	11	.118	6.89
* DS1635	16"	3.50mm	10	.138	6.98
* DS1645	16"	4.50mm	7	.177	11.20
* DS1840	18"	4.00mm	8	.157	11.53
* DS1845	18"	4.50mm	7	.177	12.93
* DS1860	18"	6.00mm	4	.236	16.74
* DS2045	20"	4.50mm	7	.177	16.00
* DS2050	20"	5.00mm	6	.197	17.67
* DS2060	20"	6.00mm	4	.236	21.04
* DS2245	22"	4.50mm	7	.177	19.74
* DS2250	22"	5.00mm	6	.197	21.83
* DS2260	22"	6.00mm	4	.236	26.00
* DS2445	24"	4.50mm	7	.177	23.59
* DS2450	24"	5.00mm	6	.197	26.07
* DS2460	24"	6.00mm	4	.236	31.09
* DS2480	24"	8.00mm	N/A	.315	38.00
* DS2660	26"	6.00mm	4	.236	37.39
* DS2675	26"	7.50mm	N/A	.295	46.37
* DS2680	26"	8.00mm	N/A	.315	49.28
* DS2860	28"	6.00mm	4	.236	43.91
* DS2875	28"	8.00mm	N/A	.315	54.92
* DS2880	28"	8.00mm	N/A	.315	57.93
* DS3080	30"	8.00mm	N/A	.315	66.70
* DS3280	32"	8.00mm	N/A	.315	78.43
* DS3290	32"	9.00mm	N/A	.354	74.50
* DS3295	32"	10.00mm	N/A	.394	92.31
* DS3612	36"	12.00MM	N/A	.472	149.05



* Disc Blades available with **DS**, **DST**, **DSA**, or **DSX** prefixes.



NORWEST

MANUFACTURING

71 SOUTH 215 WEST-RUPERT, ID- PHONE: (208) 436-1770 - FAX: (208) 436-1776

NOTCHED CONCAVE DISC BLADES

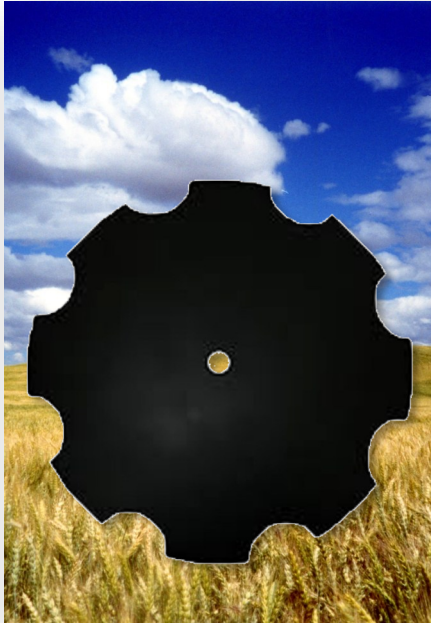

* Disc Blades available with **DN**, **DNT**, **DNA**, or **DNX** prefixes.

PART NUMBER	BLADE DIAMETER	THICKNESS			BLADE WEIGHT (LBS) (Approx.)
		mm	GAUGE	DECIMAL	
* DN1630	16"	3.00mm	11	.118	5.72
* DN1645	16"	4.50mm	7	.177	11.20
* DN1845	18"	4.50mm	7	.177	11.43
* DN1860	18"	6.00mm	4	.236	14.80
* DN2040	20"	4.00mm	8	.157	12.99
* DN2045	20"	4.50mm	7	.177	14.37
* DN2060	20"	6.00mm	4	.236	18.87
* DN2240	22"	4.00mm	8	.157	16.23
* DN2245	22"	4.50mm	7	.177	17.96
* DN2250	22"	5.00mm	6	.197	19.85
* DN2260	22"	6.00mm	4	.236	23.63
* DN2445	24"	4.50mm	7	.177	21.63
* DN2450	24"	5.00mm	6	.197	24.26
* DN2460	24"	6.00mm	4	.236	28.50
* DN2480	24"	8.00mm	N/A	.315	33.75
* DN2650	26"	5.00mm	6	.197	28.71
* DN2660	26"	6.00mm	4	.236	33.74
* DN2675	26"	7.50mm	N/A	.295	43.55
* DN2680	26"	8.00mm	N/A	.315	44.41
* DN2860	28"	6.00mm	4	.236	39.98
* DN2875	28"	7.50mm	N/A	.295	50.02
* DN2880	28"	8.00mm	N/A	.315	52.67
* DN3080	30"	8.00mm	N/A	.315	60.50
* DN3275	32"	7.5mm	N/A	.295	67.22
* DN3280	32"	8.00mm	N/A	.315	71.70
* DN3290	32"	9.00mm	N/A	.354	78.82
* DN3295	32"	10.00mm	N/A	.394	88.72
* DN3695	36"	10.00mm	N/A	.394	109.56
* DN3612	36"	12.00mm	N/A	.472	143.10

NOT ALL BLADES ARE STOCKED! PLEASE CALL FOR AVAILABILITY.



NORWEST

MANUFACTURING

71 SOUTH 215 WEST-RUPERT, ID- PHONE: (208) 436-1770 - FAX: (208) 436-1776



CONICAL DISC BLADES

PART NUMBER	BLADE DIAMETER	THICKNESS			BLADE WEIGHT (LBS) <i>(Approx.)</i>
		mm	GAUGE	DECIMAL	
SMOOTH CONICAL BLADES					
* DSC2250	22"	5.00mm	6	.197	23.20
* DSC2260	22"	6.00mm	4	.236	26.00
* DSC2450	24"	5.00mm	6	.197	29.00
* DSC2460	24"	6.00mm	4	.236	31.09
* DSC2660	26"	6.00mm	4	.236	37.39

* Disc Blades available with DSC, and DSCT prefixes.

PART NUMBER	BLADE DIAMETER	THICKNESS			BLADE WEIGHT (LBS) <i>(Approx.)</i>
		mm	GAUGE	DECIMAL	
NOTCHED CONICAL BLADES					
** DNC2245	22"	4.50mm	7	.177	17.96
** DNC2260	22"	6.00mm	4	.236	23.97
** DNC2445	24"	4.50mm	7	.177	22.26
** DNC2450	24"	5.00mm	6	.197	23.91
** DNC2460	24"	6.00mm	4	.236	28.50
** DNC2660	26"	6.00mm	4	.236	33.74

** Disc Blades available with DSC, and DSCT prefixes.

NOT ALL BLADES ARE STOCKED! PLEASE CALL FOR AVAILABILITY.



NORWEST

MANUFACTURING

71 SOUTH 215 WEST-RUPERT, ID- PHONE: (208) 436-1770 - FAX: (208) 436-1776

SMOOTH FLAT COULTER BLADES



* Disc Blades available with DSR, DSRT or DSRA prefixes.

PART NUMBER	BLADE DIAMETER	THICKNESS			BLADE WEIGHT (LBS) (Approx.)
		mm	GAUGE	DECIMAL	
SMOOTH COULTER BLADES					
* DSR1330	13"	3.00mm	11	.118	6.61
* DSR1435	14"	3.50mm	10	.138	8.91
* DSR1445	14"	4.50mm	7	.177	9.20
* DSR1630	16"	3.00mm	11	.118	6.98
* DSR1635	16"	3.50mm	10	.138	7.87
* DSR1645	16"	4.50mm	7	.177	11.40
* DSR1860	18"	6.00mm	4	.236	16.64
* DSR2050	20"	5.00mm	6	.197	16.74
* DSR2060	20"	6.00mm	4	.236	19.91
* DSR2250	22"	5.00mm	6	.197	22.11
* DSR2260	22"	6.00mm	4	.236	26.34
* DSR2460	24"	6.00mm	4	.236	29.00
* DSR2475	24"	7.50mm	N/A	.295	37.70
* DSR2480	24"	8.00mm	N/A	.315	36.66
* DSR2675	26"	7.50mm	N/A	.295	44.03
* DSR2680	26"	8.00mm	N/A	.315	46.98
* DSR2875	28"	7.50mm	N/A	.295	51.00
* DSR2880	28"	8.00mm	N/A	.315	49.14
* DSR2810	28"	10.00mm	N/A	.394	56.17
* DSR3075	30"	7.50mm	N/A	.295	56.40
* DSR3080	30"	8.00mm	N/A	.315	63.88
* DSR3290**	32"	9.00mm	N/A	.354	81.81
* DSR3495**	34"	9.50mm	N/A	.374	102.60
* DSR3410	34"	10.00mm	N/A	.394	108.00
* DSR3610**	36"	10.00mm	N/A	.394	119.20

**COULTER BLADES ARE STOCKED WITH A 3/4" ROUND PILOT HOLE.
 NORWEST WILL CUT TO DESIRED HUB PATTERN.
 NOT ALL BLADES ARE STOCKED!
 PLEASE CALL FOR AVAILABILITY.
 MANUFACTURED BY NORWEST



NORWEST



MANUFACTURING

71 SOUTH 215 WEST-RUPERT, ID- PHONE: (208) 436-1770 - FAX: (208) 436-1776

NOTCHED FLAT COULTER BLADES

PART NUMBER	BLADE DIAMETER	THICKNESS			BLADE WEIGHT (LBS) (Approx.)
		mm	GAUGE	DECIMAL	
NOTCHED COULTER BLADES					
* DNR1330	13"	3.00mm	11	.118	4.45
* DNR1630	16"	3.00mm	11	.118	6.10
* DNR1835	18"	3.50mm	10	.138	8.39
* DNR1860	18"	6.00mm	4	.236	14.80
* DNR2050	20"	5.00mm	6	.197	14.91
* DNR2250	22"	5.00mm	6	.197	20.11
* DNR2460	24"	6.00mm	4	.236	26.38
* DNR2475	24"	7.50mm	N/A	.295	34.50
* DNR2480	24"	8.00mm	N/A	.315	35.17
* DNR2675	26"	7.50mm	N/A	.295	40.46
* DNR2680	26"	8.00mm	N/A	.315	43.17
* DNR2875	28"	7.50mm	N/A	.295	48.40
* DNR2880	28"	8.00mm	N/A	.315	51.62
* DNR3410	34"	10.00mm	N/A	.394	103.00

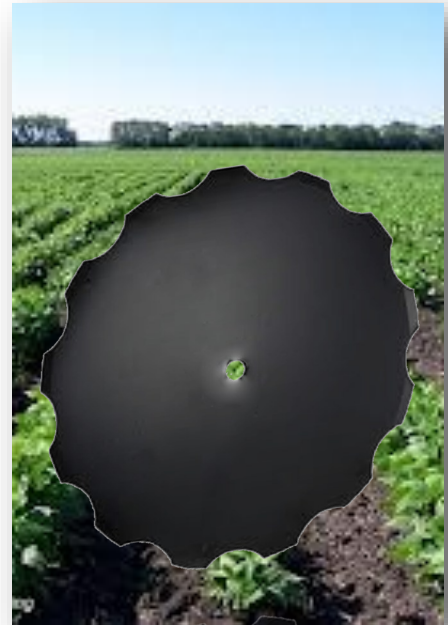

* Disc Blades available with **DNR**, **DNRT** or **DNRA** prefixes.

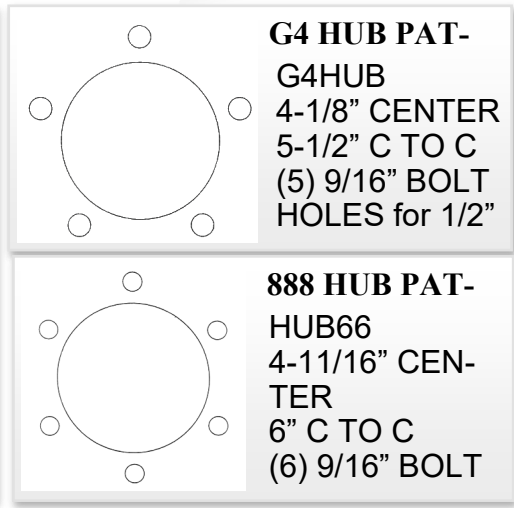
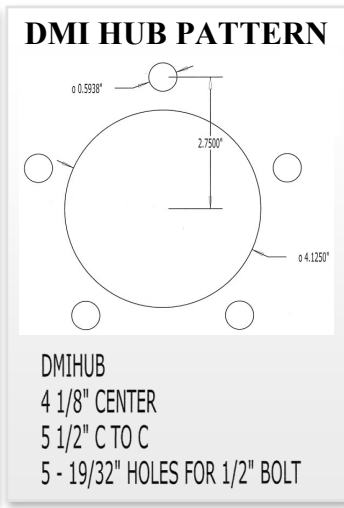
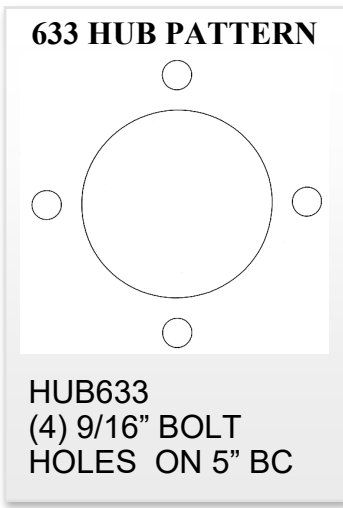

**COULTER BLADES ARE STOCKED WITH A 3/4" ROUND PILOT HOLE.
 NORWEST WILL CUT TO DESIRED HUB PATTERN.
 NOT ALL BLADES ARE STOCKED!
 PLEASE CALL FOR AVAILABILITY.**



NORWEST

MANUFACTURING

71 SOUTH 215 WEST-RUPERT, ID- PHONE: (208) 436-1770 - FAX: (208) 436-1776

FLAT CENTER COULTER BLADES



* Disc Blades available with **DSF**, **DSFT**, **DSFA**, **DSFF** and **DSFA** prefixes.

** Disc Blades available with **DNF**, **DNFT**, **DNFA**, **DNFF** and **DNFA** prefixes.

PART NUMBER	BLADE DIAMETER	THICKNESS			BLADE WEIGHT (LBS) (Approx.)
		mm	GAUGE	DECIMAL	
SMOOTH RAISED FLAT CENTER BLADES					
* DSF2045	20"	4.50mm	7	.177	16.00
* DSF2260	22"	6.00mm	4	.236	26.00
* DSF2460	24"	6.00mm	4	.236	31.09
* DSF2660	26"	6.00mm	4	.236	37.39
* DSF2675	26"	7.50mm	N/A	.295	46.20
* DSF2680	26"	8.00mm	N/A	.315	49.28
* DSF2860	28"	6.00mm	4	.236	43.91
* DSF2875	28"	7.50mm	N/A	.295	54.30
* DSF2880	28"	8.00mm	N/A	.315	57.93
* DSF3280	32"	8.00mm	N/A	.315	77.33
SMOOTH RAISED FLAT CENTER BLADES with 633 HUB PATTERN					
* DSF2260-633	22"	6.00mm	4	.236	24.63
NOTCHED RAISED FLAT CENTER BLADES					
** DNF2045	20"	4.50mm	7	.177	14.37
** DNF2260	22"	6.00mm	4	.236	23.63
** DNF2460	24"	6.00mm	4	.236	28.50
** DNF2660	26"	6.00mm	4	.236	33.74
** DNF2675	26"	7.50mm	N/A	.295	43.28
** DNF2680	26"	8.00mm	N/A	.315	46.17
** DNF2860	28"	6.00mm	4	.236	39.98
** DNF2875	28"	7.50mm	N/A	.295	49.95
** DNF2880	28"	8.00mm	N/A	.315	52.67
** DNF3280	32"	8.00mm	N/A	.315	71.70

NOT ALL BLADES ARE STOCKED! PLEASE CALL FOR AVAILABILITY.



NORWEST

MANUFACTURING

71 SOUTH 215 WEST-RUPERT, ID- PHONE: (208) 436-1770 - FAX: (208) 436-1776



WAY COULTER BLADES

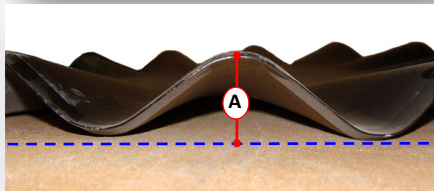

PART NUMBER	BLADE DIAMETER	THICKNESS			BLADE WEIGHT (LBS) (Approx.)	WAVE MEAS. (A)
		mm	GAUGE	DECIMAL		
DSR2460-W	24"	6.00mm	4	.236	29.00	1-1/8"
DSR2480-W	24"	8.00mm	N/A	.315	36.66	1-1/8"
DSR2680-W	26"	8.00mm	N/A	.315	46.98	1-1/4"
DSR2875-W	28"	7.50mm	N/A	.295	51.00	1-7/16"
DSR2880-W	28"	8.00mm	N/A	.315	49.14	1-5/16"
DSR2810-W	28"	10.00mm	N/A	.394	56.17	1-3/8"
DSR3080-W	30"	8.00mm	N/A	.315	57.00	1-3/8"
8 WAVE, 13 WAVE, & 25 WAVE COULTERS						
DSW1645- <u>13</u> (Indicates # of waves per blade)						
DSW1645-13	16"	4.50mm	7	.177	11.25	3/4"
DSW1645-25	16"	4.50mm	7	.177	11.25	5/16"
DSW1840-08	18"	4.00mm	8	.157	10.86	1-3/4"
DSW1840-13	18"	4.00mm	8	.157	10.86	7/8"
DSW2045-08	20"	4.50mm	7	.177	15.15	2-3/8"
DSW2045-13	20"	4.50mm	7	.177	15.15	1"
DSW2245-08	22"	4.50mm	7	.177	17.73	2-1/4"
DSW2245-13	22"	4.50mm	7	.177	17.73	1"

FLUTED COULTER BLADES

PART NUMBER	BLADE DIAMETER	THICKNESS			BLADE WEIGHT (LBS) (Approx.)
		mm	GAUGE	DECIMAL	
DSS1845	18"	4.50mm	7	.177	12.20
DSS2045	20"	4.50mm	7	.177	15.15
*DSS2245	22"	4.50mm	7	.177	20.00

* DSS2245 is fluted with an edge; other fluted blades have no edge.

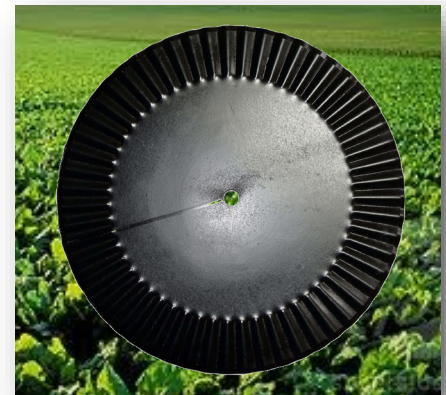

Blades 300-16

Fluted Coultter Blades available with **DSS**, **DSST** or **DSSA** prefixes.

www.norwest-mfg.com

COULTER BLADES ARE STOCKED WITH A 3/4" ROUND PILOT HOLE. NORWEST WILL CUT TO DESIRED HUB PATTERN. NOT ALL BLADES ARE STOCKED! PLEASE CALL FOR AVAILABILITY.



NORWEST

MANUFACTURING

71 SOUTH 215 WEST-RUPERT, ID- PHONE: (208) 436-1770 - FAX: (208) 436-1776

Flat Coulter Hub Patterns		
	<p>AL Center Hole: 1-1/8" x 1-1/4" ds Bolt Circle (C to C): N/A Bolt Holes: N/A</p>	To Fit: Allis Chalmers and IH coulters chisel and others including Calkins and Glencoe/Farmland
	<p>AC Center Hole: 1-3/16" Bolt Circle (C to C): 3-1/4" Bolt Holes: (6) 13/32"</p>	To Fit: Allis Chalmers and others
	<p>B Center Hole: 1-1/2" sq. Bolt Circle (C to C): N/A Bolt Holes: N/A</p>	To Fit: Brillion Soil Builder and others
	<p>CA Center Hole: 2-1/4" Bolt Circle (C to C): 3-1/2" Bolt Holes: (6) 13/32"</p>	To Fit: Case EX series bottoms and others
	<p>D Center Hole: 1-1/8" sq. Bolt Circle (C to C): N/A Bolt Holes: N/A</p>	To Fit: John Deere 712 Mulcher and others
	<p>F Center Hole: 4-1/8" Bolt Circle (C to C): 5-1/2" Bolt Holes: (5) 17/32"</p>	<p>To Fit: Flex King and others including Miller Weeder, Noble/Versatile, Roll a Cone, and Sunflower. <i>Norwest's common DMI pattern</i></p>
	<p>FD-4 Center Hole: 2-7/32" Bolt Circle (C to C): 3-13/32" Bolt Holes: (4) 1/4"</p>	To Fit: Ford and others

**COULTER BLADES ARE STOCKED WITH A 3/4" ROUND PILOT HOLE.
 NORWEST WILL CUT TO DESIRED HUB PATTERN. NOT ALL BLADES ARE STOCKED!
 PLEASE CALL FOR AVAILABILITY.**

Flat Coulter Hub Patterns

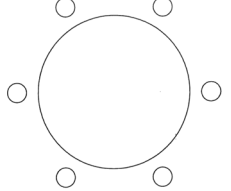
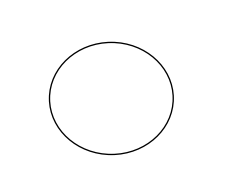
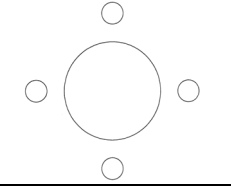
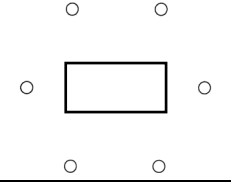
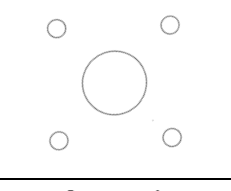
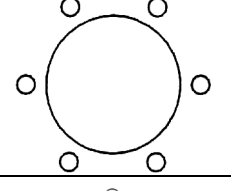
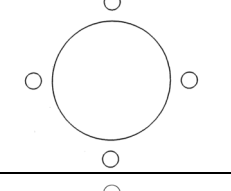
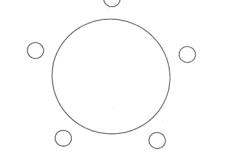
	<p style="text-align: center;">FD-6 Center Hole: 2-13/16" Bolt Circle (C to C): 4-1/8" Bolt Holes: (6) 3/8"</p>	<p style="text-align: center;">To Fit: Ford and others</p>
	<p style="text-align: center;">G Center Hole: 1-1/2" rd. Bolt Circle (C to C): N/A Bolt Holes: N/A</p>	<p>To Fit: Glencoe/Farmland Soil Saver and others including Allis Chalmers Mini Till, Bush Hog Soil Hog, Case, DMI, Ford, Hiniker, IH, Kent, Landoll, Noble, and Orthman</p>
	<p style="text-align: center;">H Center Hole: 2-1/2" Bolt Circle (C to C): 4" Bolt Holes: (4) 17/32"</p>	<p>To Fit: Hiniker and others including Black Machine, Brillion, DMI, Glencoe/Farmland, Haybuster, Landoll, Sukup, United Farm Tools, and Wil-Rich/Noble</p>
	<p style="text-align: center;">IH Center Hole: 31/32" x 1-11/32" Bolt Circle (C to C): 3-1/4" Bolt Holes: (6) 11/32"</p>	<p style="text-align: center;">To Fit: IH older style and others</p>
	<p style="text-align: center;">IHN Center Hole: 1-1/2" Bolt Circle (C to C): 4-1/2" Bolt Holes: (4) 17/32"</p>	<p style="text-align: center;">To Fit: IH newer style including 720, 800, and others</p>
	<p style="text-align: center;">JD Center Hole: 2" Bolt Circle (C to C): 3-1/2" Bolt Holes: (6) 13/32"</p>	<p style="text-align: center;">To Fit: John Deere HS and NU bottoms (non-metric) and others including Yetter</p>
	<p style="text-align: center;">JDD Center Hole: 3" Bolt Circle (C to C): 4-3/8" Bolt Holes: (4) 13/32"</p>	<p style="text-align: center;">To Fit: John Deere 750 Drill and others</p>
	<p style="text-align: center;">JDM Center Hole: 2-1/8" Bolt Circle (C to C): 4-3/4" Bolt Holes: (5) 33/64"</p>	<p style="text-align: center;">To Fit: John Deere NU 450 Metric bottoms and others including Yetter</p>

Flat Coultter Hub Patterns

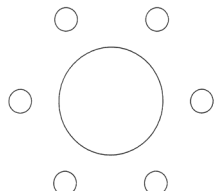
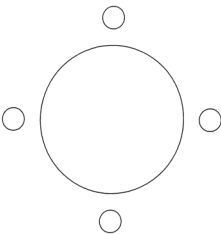
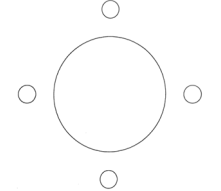
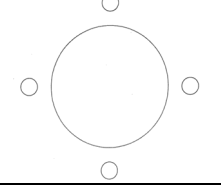
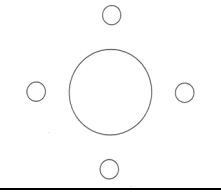
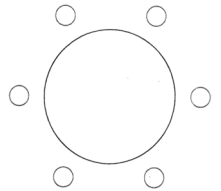
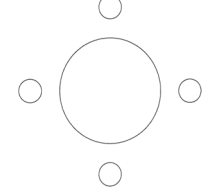
	<p style="text-align: center;">K Center Hole: 2" Bolt Circle (C to C): 3-3/8" Bolt Holes: (6) 13/32"</p>	<p>To Fit: Kinze and others including Black Machine</p>
	<p style="text-align: center;">MLWR Center Hole: 3-11/16" Bolt Circle (C to C): 5" Bolt Holes: (4) 17/32"</p>	<p style="text-align: center;">To Fit: Melroe/Wil-Rich</p> <p>This is a very common agricultural hub used by Acra Plant, Ag Systems, Bingham Bros., Caldwell-Hamby, DMI, Flexi Coil, Harrell, Landoll, Marliss, Monroe Tufline, Noble, Sunflower, Thurston/Blu Jet, Tye, United Farm Tools, Wiese, Wetherell, York Agri Prod., and others</p>
	<p style="text-align: center;">MF Center Hole: 3.172" Bolt Circle (C to C): 4-3/4" Bolt Holes: (4) 15/32"</p>	<p style="text-align: center;">To Fit: Massey Ferguson and others</p>
	<p style="text-align: center;">OL Center Hole: 4" Bolt Circle (C to C): 5-1/4" Bolt Holes: (4) 17/32"</p>	<p>To Fit: Oliver/White and others including Great Plains, KBH, Marliss, Underferth, and Yetter</p>
	<p style="text-align: center;">ORT Center Hole: 2-11/16" Bolt Circle (C to C): 4-1/4" Bolt Holes: (4) 13/32"</p>	<p style="text-align: center;">To Fit: Orthman and others</p>
	<p style="text-align: center;">R Center Hole: 3-3/4" Bolt Circle (C to C): 5" Bolt Holes: (6) 7/16"</p>	<p style="text-align: center;">To Fit: Rawson and others</p>
	<p style="text-align: center;">W Center Hole: 2-1/2" Bolt Circle (C to C): 4" Bolt Holes: (4) 13/32"</p>	<p>To Fit: Wetherell and others including Alloway, Kongskilde, Lorenz, Noble, P & H, and Tebben</p>

***COULTTER BLADES ARE STOCKED WITH A 3/4" ROUND PILOT HOLE.
 NORWEST WILL CUT TO DESIRED HUB PATTERN. NOT ALL BLADES ARE STOCKED!
 PLEASE CALL FOR AVAILABILITY.***

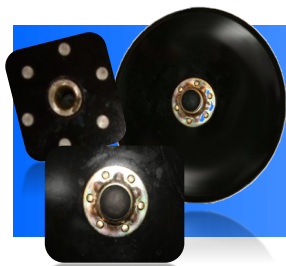

PLANTER/SEEDER BLADES

PART NUMBER	OEM NUMBER	BLADE DIAMETER	THICKNESS			BLADE WEIGHT (LBS) (Approx.)	DUST CAP
			mm	GAUGE	DECIMAL		
FOR JOHN DEERE: MAXI MERGE OPENER BLADES							
DPAA53860	AA38460	15"	3.50mm	10	.138	7.00	YES
DPAA53860D**	AA38460	15"	3.50mm	10	.138	7.00	YES
DPAA55927	AA55927	15"	3.00mm	11	.118	6.90	YES
DPAA65248 <i>(Double Bearing)</i>	AA65248	15"	3.50mm	10	.138	7.10	YES
DPAA72357 <i>(Blade Only)</i>	AA72357 (For AA55927 Assembly)	15"	3.00mm	11	.118	6.20	N/A
DPAA283804 <i>(Blade Only)</i>	N283804 (750 SERIES)	18"	5.00mm	6	.197	14.90	N/A
FOR CASE IH							
DPC6318L	84416318-L	14"	4.50mm	7	.177	5.80	NO
DPC6319T	84416319-L	14"	4.50mm	7	.177	5.80	NO
FOR GREAT PLAINS							
DPGP135S	107-135S	13-1/2"	3.00mm	11	.118	8.50	YES
DPGP138S	107-138S	13-1/2"	4.0mm	8	.157	8.91	YES
NOT ALL BLADES ARE STOCKED! PLEASE CALL FOR AVAILABILITY.							



Part #: DPAA53860

www.norwest-mfg.com



NORWEST

MANUFACTURING

71 SOUTH 215 WEST-RUPERT, ID- PHONE: (208) 436-1770 - FAX: (208) 436-1776



ADDITIONAL PLANTER BLADES

PART NUMBER	OEM NUMBER	BLADE DIAMETER	THICKNESS			BLADE WEIGHT (LBS) (Approx.)
			mm	GAUGE	DECIMAL	
DSR1850-3025A	Seed Disc with 3.781" Center. 6" on 5" Bolt Center to Center	18"	5.0mm	6	0.197	16.00 LBS
DSR2470-2026A	Seed Disc with 4.016" Center. 6" on 8" Bolt Center to Center	24"	7.0mm	N/A	0.315	36.66 LBS

NOT ALL BLADES ARE STOCKED! PLEASE CALL FOR AVAILABILITY.

CHINA CAP DRILL BLADES

FOR JOHN DEERE GRAIN DRILLS & AIR DRILL SEEDERS

PART NUMBER	OEM NUMBER	BLADE DIAMETER	THICKNESS			BLADE WEIGHT (LBS) (Approx.)
			mm	GAUGE	DECIMAL	
DS-N161594*	N164594 2833805	13-1/2"	3.50mm	10	.138	4.58

NON-RAISED FLAT CENTER BLADES WITH PRE-CUT HUB PATTERNS

PART NUMBER	BLADE DIAMETER	THICKNESS			BLADE WEIGHT (LBS) (Approx.)
		mm	GAUGE	DECIMAL	
NON RAISED FLAT CENTER SMOOTH BLADES with DMI HUB PATTERN					
DSFF2060-DMI	20"	6.00mm	4	.236	21.04
DSFF2260-DMI	22"	6.00mm	4	.236	26.00
DSFF2460-DMI	24"	6.00mm	4	.236	31.90
NON RAISED FLAT CENTER NOTCHED BLADES with DMI HUB PATTERN					
DNFF2060-DMI	20"	6.00mm	4	.236	18.87
DNFF2260-DMI	22"	6.00mm	4	.236	23.63
DNFF2460-DMI	24"	6.00mm	4	.236	28.50
NON RAISED FLAT CENTER SMOOTH BLADES with 633 HUB PATTERN					
DSFF2060-633	20"	6.0mm	4	.236	20.14

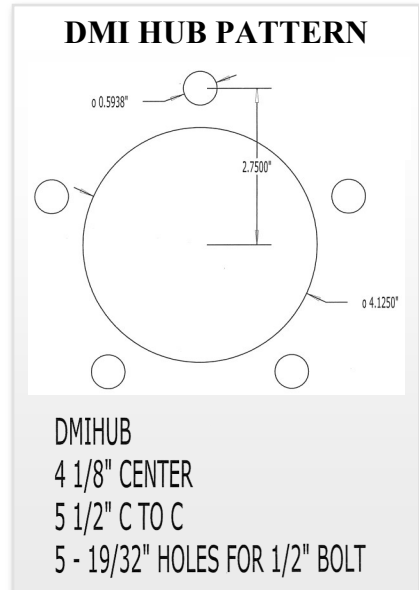

NOT ALL BLADES ARE STOCKED! PLEASE CALL FOR AVAILABILITY.







NORWEST

MANUFACTURING

71 SOUTH 215 WEST-RUPERT, ID- PHONE: (208) 436-1770 - FAX: (208) 436-1776

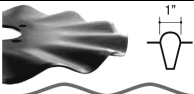
SEED DISC USE TABLE

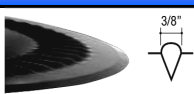
	Soil Tilling Action			Soil Tilth (condition of Tilled Soil)				Soil Conditions				Speed			Tillage Practice		
	low	Moderate	High	High	Medium	Fine	Extra Fine	Dry	Humid	Sandy	Thick	Low	Medium	High	Direct	Conservation	Conventional
Flat																	
	◇							◇	◇	◇	◇			◇	◇	◇	◇
Notched Flat																	
	◇							◇		◇	◇			◇	◇	◇	◇
8 Waves																	
			◇	◇	◇			◇		◇	◇			◇	◇	◇	◇
13 Waves																	
			◇	◇	◇	◇		◇		◇	◇			◇	◇	◇	◇
25 Waves																	
		◇					◇	◇		◇	◇			◇	◇	◇	◇
50 Waves (Fluted)																	
	◇				◇			◇	◇	◇	◇			◇	◇	◇	◇
50 Waves (Fluted with Edge)	<i>*Available on DSS2245-00 Only</i>																
	◇							◇	◇	◇	◇			◇	◇	◇	◇



NORWEST

MANUFACTURING

71 SOUTH 215 WEST-RUPERT, ID- PHONE: (208) 436-1770 - FAX: (208) 436-1776



SPECIALTY BLADES WITH PRE-CUT HUB PATTERNS & CENTER HOLES

A	B	C	D
E	F	G	H
I	J	K	L
M	Lenlock Hub Pattern	New Lockwood Hub Pattern	N
	<p>3-3/4" Center (6) 9/16" Holes for 1/2" Bolts 5-1/4" Center to Center</p>	<p>4-11/16" Center. (6) slotted holes for 1/2" bolts on 5-1/4" C to C. (6) Rnd. holes on 6" C to C for 1/2" Bolts.</p>	

NOT ALL BLADES ARE STOCKED! PLEASE CALL FOR AVAILABILITY.

SPECIALTY BLADES WITH PRE-CUT HUB PATTERNS & CENTER HOLES

PART NUMBER	DESCRIPTION	PRE-CUT PATTERN	BLADE DIAMETER	THICKNESS mm	BLADE WEIGHT (Approx.)	REFERENCE PHOTO
16-001230	Weeder Blade	(5) .343 holes on 3" Bolt Centers with 1-3/8" Center	12"	3.00mm	3.30 LBS	A
16-001440	Weeder Blade	(5) .343 Holes on 3" Bolt Centers with 1 -3/8" Center	14"	3.00mm	4.69 LBS	B
DS10140-NS	Smooth Disc Blade	1-3/16" Square Hole	10"	3.00mm	2.88 LBS	C
DS1025-ACME	Smooth Disc Blade	3/4" Round Pilot Hole	10"	2.50mm	2.07 LBS	D
DSA905-10078	Smooth Concave Disc for Parma & Alloway Scalper	1" Square Center. 8" Center to Center. (4) 7/16" Square Holes for 3/8" Bolts	16"	3.50mm	7.66 LBS	F
DSLW804-16	Smooth Covering Disc for Lockwood	No Center Hole Cut. 3-1/8" Bolt Center to Center. (3) 21/64" Holes for 5/16" Bolts	14"	3.50mm	5.53 LBS	G
DSLW804-56	Smooth Covering Disc for Lockwood	No Center Hole Cut. 3-1/8" Bolt Center to Center. (3) 21/64" Holes for 5/16" Bolts	16"	3.50mm	7.77 LBS	G
DSNK210098	Smooth Concave Disc for Spudnik	(4) 9/16" Holes on 5" Center to Center	16"	3.50mm	10.24 LBS	H
DSR2060-MR	Smooth Flat Coultter Blade with Melroe Hole Pattern	3-11/16" Center. (4) 17/32" Bolt Holes on 5" Center to Center	20"	6.00mm	18.10 LBS	I
DS1445-OM	Smooth Disc for Orthman	3" Center Hole with (6) 7/16" Square Holes for 3/8" Bolts on 4-1/4" Center to Center	14"	4.50mm	7.21 LBS	E
DSR2060-OM	Smooth Flat Coultter Blade with Orthman Hole Pattern	3" Center Hole with (6) 7/16" Square Holes for 3/8" Bolts on 4-1/4" Center to Center	20"	6.00mm	19.91 LBS	E
DSR2460-LW	Smooth Flat Coultter with Lockwood Hole Pattern	Old Lockwood: 3-3/4" Center. (6) 9/16" Holes for 1/2" Bolts on 5-1/4" Center to Center	24"	6.00mm	27.03 LBS	J
DSR2480-LW	Smooth Flat Coultter with Lockwood Hole Pattern	New Lockwood: 4-11/16" Center. (6) slotted holes for 1/2" bolts on 5-1/4" C to C. (6) Rnd. holes on 6" C to C for 1/2" Bolts. <i>Fits Old & New Lockwood Hubs</i>	24"	8.00mm	36.66	K
DSR2810-SP/ DSR3410-SP	Smooth Flat Coultter with Spudnik Hole Pattern	4-1/16" Center. 5-1/4" Bolt Center to Center. (6) 9/16" holes for 1/2" Bolts	28" / 34"	10mm	61.00 / 75.00 LBS	L
DSRJD10268	Smooth Coultter for JD Grain, Woods & WIC Scalper	1-3/16" Rnd. Center Hole with (6) 5/16" Rnd. Bolt Holes on 2-1/2" Bolt Center to Center	12"	3mm	3.57 LBS	M
16-00662	Disc Assembly W/ Hub & "Blade	(5) .343 holes on 3" Bolt Centers with 1-3/8" Center	12"	3.00mm	6.92 LBS	N



NORWEST

MANUFACTURING

71 SOUTH 215 WEST-RUPERT, ID- PHONE: (208) 436-1770 - FAX: (208) 436-1776



SCALPER BLADES

NORWEST PART NUMBER	ITEM DESCRIPTION	BLADE WEIGHT (Approximate)	MEAS. (A)	MEAS. (B)
281116	Scalper Blade for Parma with Bevel around corner. <i>Heat Treated</i>	2.01 LBS	4-1/2"	13-3/16"
281117	Scalper Blade for WIC with Bevel around corner. <i>Heat Treated</i>	2.61 LBS	6-7/8"	11-7/8"

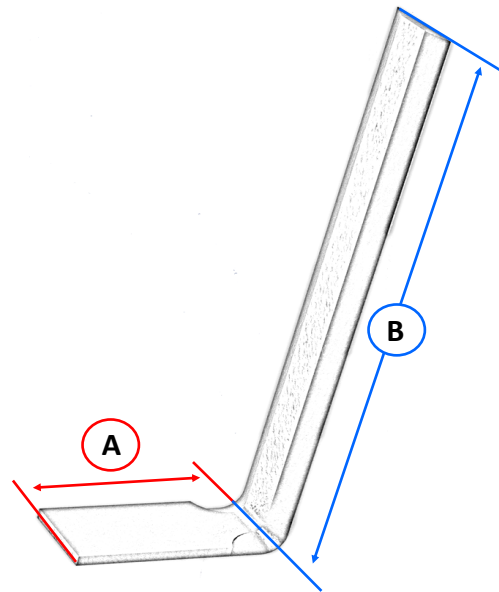



NORWEST

MANUFACTURING

71 SOUTH 215 WEST-RUPERT, ID- PHONE: (208) 436-1770 - FAX: (208) 436-1776

CUSTOM LOADER & SCRAPER BLADES

HOW TO ORDER CUSTOM BLADES:

The pictures below are an illustration of how to order your scraper blade. (FIG. A)

Please see Page 300-31 for an ordering template.

Make copies of the page, and fax to Norwest Mfg. to place your custom loader blade order.

1. Measure the thickness of the blade. (A) FIG. 1A
 2. Measure total length of the blade. (B) FIG. 1
 3. Measure from the top of blade to the bottom to obtain the width of the blade. (C) FIG. 1
 4. Measure from the top of the blade to the center of the first hole to determine hole placement for single bevel blade. (D) FIG. 1
 5. For Proper hole spacing:
 - 1st Measurement– measure from left edge of the blade to the center of the first hole. (E) FIG. 1
 - 2nd Measurement– measure from center of first hole to center of second hole. (F) FIG. 1
 Continue with this method until each hole is measured. (E) through (J) etc. FIG. 1
- If you have difficulty measuring hole centers, refer to FIG. 3.

FIG. A

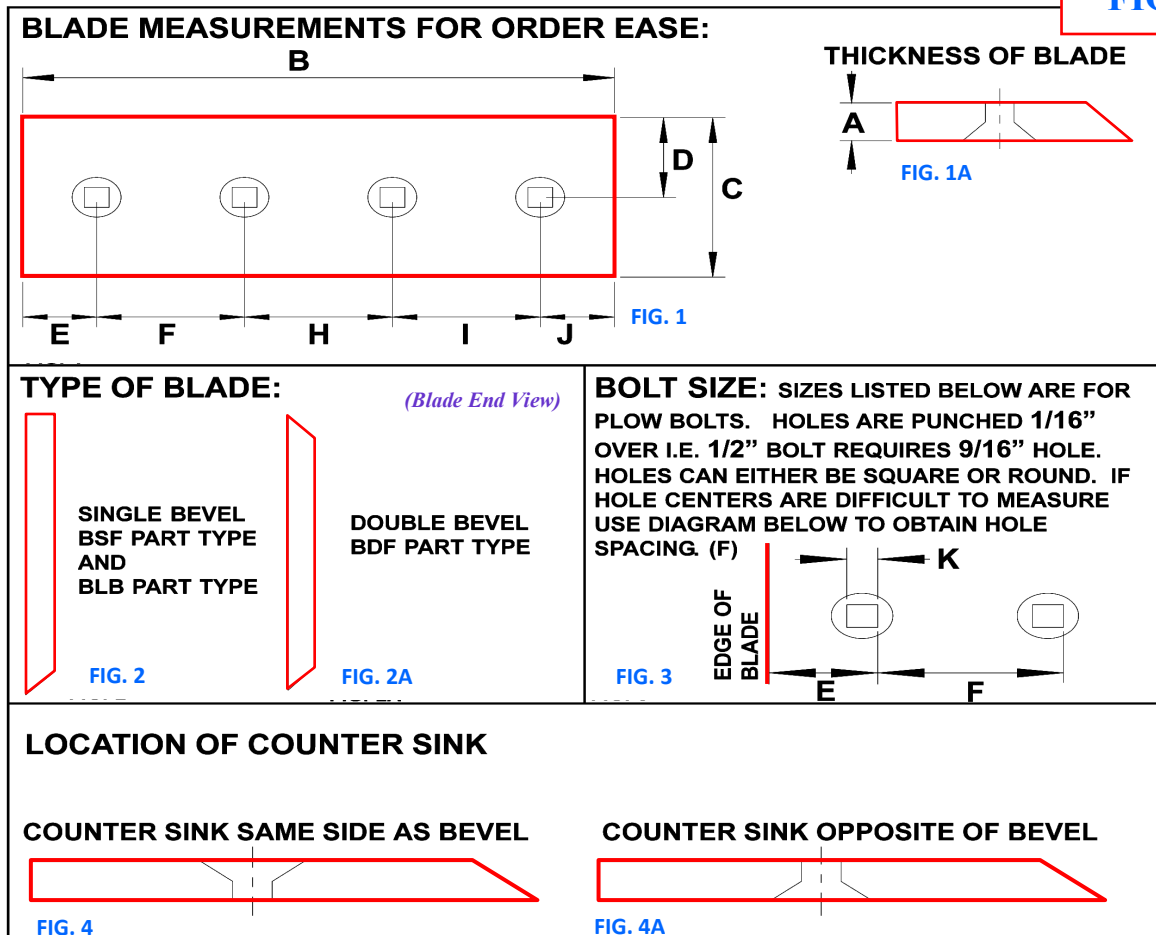

NORWEST MFG INTERNAL WORK ORDER

CUSTOMER _____ PART # _____

DOUBLE BEVEL _____
SINGLE BEVEL _____

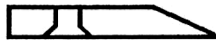

COUNTERSINK OPPOSITE OF BEVEL

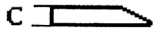

COUNTERSINK SAME AS BEVEL

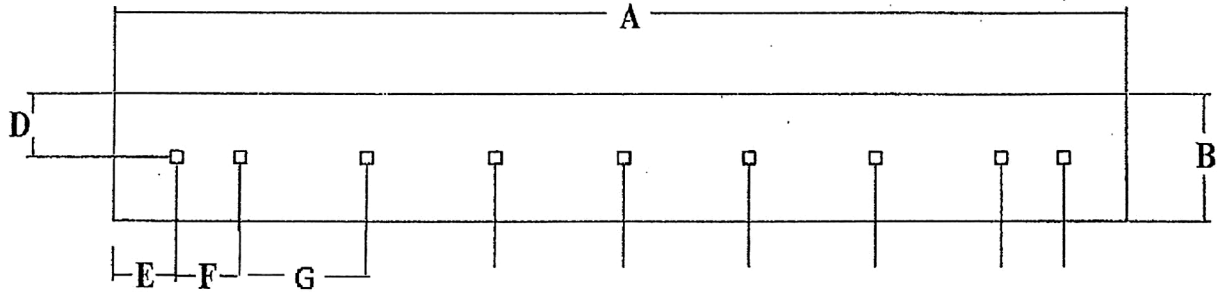

HOLE SIZE



H

A _____ OVERALL LENGTH IN INCHES

B _____ OVERALL HEIGHT IN INCHES

C _____ THICKNESS OF MATERIAL

** D _____ MEASUREMENT FROM TOP OF BLADE TO CENTER OF ROW OF HOLES

E _____ OUTSIDE EDGE MEASUREMENT TO CENTER OF 1ST HOLE

F _____ MEASUREMENT FROM CENTER OF 1ST HOLE TO CENTER OF 2ND HOLE

G _____ MEASUREMENT FROM CENTER OF 2ND HOLE TO CENTER OF 3RD HOLE

CONTINUE WITH THIS METHOD UNTIL EACH HOLE IS MEASURED

H _____ SIZE OF PLOWBOLT

I _____ NUMBER OF BOLT HOLES

****NOTE** ROW OF HOLES FOR DOUBLE BEVEL BLADES ARE USUALLY RIGHT IN THE CENTER OF THE BLADE AND ROW OF HOLES FOR SINGLE BEVEL ARE OFFSET. MAKE SURE TO PUT MEASUREMENT ON LINE "D"**

MEASURED BY: _____ DATE: _____



PLEASE COPY THIS PAGE AND USE IT TO PLACE YOUR CUSTOM BLADE ORDERS.



NORWEST

MANUFACTURING

71 SOUTH 215 WEST-RUPERT, ID- PHONE: (208) 436-1770 - FAX: (208) 436-1776

CUSTOM LOADER & SCRAPER BLADES

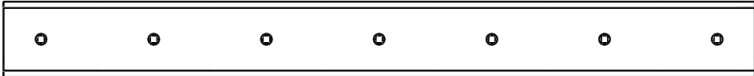

PART NUMBER	BLADE DIMENSIONS	WEIGHT OF BLADE per ft.	PART NUMBER	BLADE DIMENSIONS	WEIGHT OF BLADE per ft.
CUSTOM FLAT BLADE: DOUBLE BEVEL-REVERSIBLE					
BDF3806	3/8" X 6" X CUSTOM	7.65 lbs.	BDF3412	3/4" X 12" X CUSTOM	30.63 lbs.
BDF1204	1/2" X 4" X CUSTOM	6.81 lbs.	BDF3414	3/4" X 14" X CUSTOM	35.73 lbs.
BDF1205	1/2" X 5" X CUSTOM	8.51 lbs.	BDF1006	1" X 6" X CUSTOM	20.42 lbs.
BDF1206	1/2" X 6" X CUSTOM	10.21 lbs.	BDF1008	1" X 8" X CUSTOM	27.23 lbs.
BDF1208	1/2" X 8" X CUSTOM	13.61 lbs.	BDF1010	1" X 10" X CUSTOM	34.03 lbs.
BDF3406	3/4" X 6" X CUSTOM	15.31 lbs.	BDF1012	1" X 12" X CUSTOM	40.84 lbs.
BDF3408	3/4" X 8" X CUSTOM	20.41 lbs.	BDF1014	1" X 14" X CUSTOM	47.65 lbs.
BDF3410	3/4" X 10" X CUSTOM	25.52 lbs.	BDF1016	1" X 16" X CUSTOM	54.45 lbs.



PART NUMBER	BLADE DIMENSIONS	WEIGHT OF BLADE per ft.	PART NUMBER	BLADE DIMENSIONS	WEIGHT OF BLADE per ft.
WELD-ON CUSTOM FLAT LOADER BLADE W/SINGLE BEVEL W/O HOLES					
BLB3803	3/8" X 3" X CUSTOM	3.89 lbs.	BLB3408	3/4" X 8" X CUSTOM	20.41 lbs.
BLB3804	3/8" X 4" X CUSTOM	5.14 lbs.	BLB3410	3/4" X 10" X CUSTOM	25.52 lbs.
BLB3806	3/8" X 6" X CUSTOM	7.65 lbs.	BLB3412	3/4" X 12" X CUSTOM	30.63 lbs.
BLB3808	3/8" X 8" X CUSTOM	10.21 lbs.	BLB3416	3/4" X 16" X CUSTOM	40.84 lbs.
BLB1203	1/2" X 3" X CUSTOM	5.02 lbs.	BLB1006	1" X 6" X CUSTOM	20.42 lbs.
BLB1204	1/2" X 4" X CUSTOM	6.86 lbs.	BLB1008	1" X 8" X CUSTOM	27.23 lbs.
BLB1205	1/2" X 5" X CUSTOM	8.58 lbs.	BLB1010	1" X 10" X CUSTOM	34.03 lbs.
BLB1206	1/2" X 6" X CUSTOM	10.21 lbs.	BLB1012	1" X 12" X CUSTOM	40.84 lbs.
BLB1208	1/2" X 8" X CUSTOM	13.61 lbs.	BLB1016	1" X 16" X CUSTOM	54.45 lbs.
BLB3406	3/4" X 6" X CUSTOM	15.31 lbs.			



NORWEST

MANUFACTURING



71 SOUTH 215 WEST-RUPERT, ID- PHONE: (208) 436-1770 - FAX: (208) 436-1776

CUSTOM LOADER BLADES

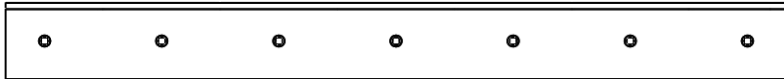

PART NUMBER	BLADE DIMENSIONS	WEIGHT OF BLADE per ft.	PART NUMBER	BLADE DIMENSIONS	WEIGHT OF BLADE per ft.
CUSTOM FLAT BLADE WITH SINGLE BEVEL					
BSF3803	3/8" X 3" X CUSTOM	3.89 lbs.	BSF3408	3/4" X 8" X CUSTOM	20.41 lbs.
BSF3804	3/8" X 4" X CUSTOM	5.14 lbs.	BSF3410	3/4" X 10" X CUSTOM	25.52 lbs.
BSF3805	3/8" X 5" X CUSTOM	6.38 lbs.	BSF3412	3/4" X 12" X CUSTOM	30.63 lbs.
BSF3806	3/8" X 6" X CUSTOM	7.65 lbs.	BSF1006	1" X 6" X CUSTOM	20.42 lbs.
BSF3808	3/8" X 8" X CUSTOM	10.21 lbs.	BSF1008	1" X 8" X CUSTOM	27.23 lbs.
BSF3810	3/8" X 10" X CUSTOM	12.76 lbs.	BSF1010	1" X 10" X CUSTOM	34.03 lbs.
BSF1204	1/2" X 4" X CUSTOM	6.86 lbs.	BSF1012	1" X 12" X CUSTOM	40.84 lbs.
BSF1206	1/2" X 6" X CUSTOM	10.21 lbs.	BSF1014	1" X 14" X CUSTOM	47.65 lbs.
BSF1208	1/2" X 8" X CUSTOM	13.61 lbs.	BSF1016	1" X 16" X CUSTOM	54.45 lbs.
BSF3406	3/4" X 6" X CUSTOM	15.31 lbs.			

****OTHER BLADE SIZES AVAILABLE. PLEASE CALL FOR DETAILS***



NORWEST

MANUFACTURING

71 SOUTH 215 WEST-RUPERT, ID- PHONE: (208) 436-1770 - FAX: (208) 436-1776

DIKER PADDLE BLADES

Norwest manufactures a wide variety of Paddle Diker blades for various machines. These blades are made from A514-T1 steel. Custom Blades can be made upon request. Most blades are made from 3/8" thick material but can be made from other thicknesses if needed.

STYLES	PREFIX	DESCRIPTION
#1	DK	Standard Triangle Shape with <i>No Bevel</i>
#2	DKB	Standard Triangle shape with <i>Bevel</i>
#3	DKU	Standard Triangle shape, <i>No Bevel</i> , with universal hole
#4	DKS	Square or Rectangular shape with <u>No Bevel</u>
#5	DKR	Diamond shaped for reversible use

STYLE DK

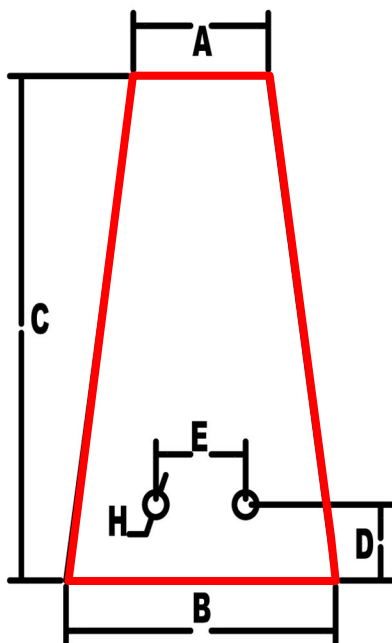

STYLE DKB

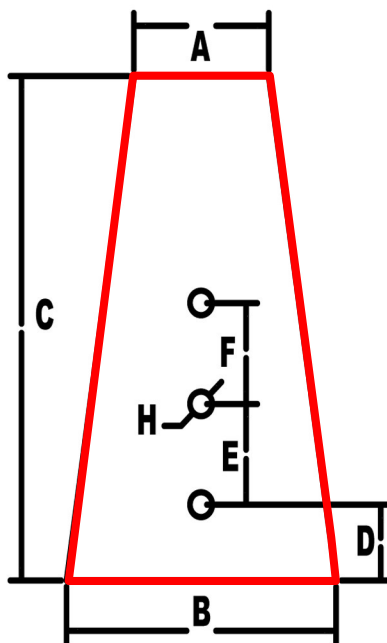

STYLE DKU

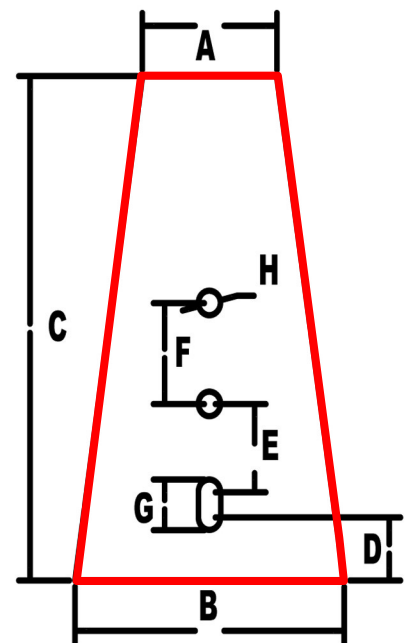



NORWEST

MANUFACTURING

71 SOUTH 215 WEST-RUPERT, ID- PHONE: (208) 436-1770 - FAX: (208) 436-1776



DIKER PADDLE BLADES

STYLE DKS

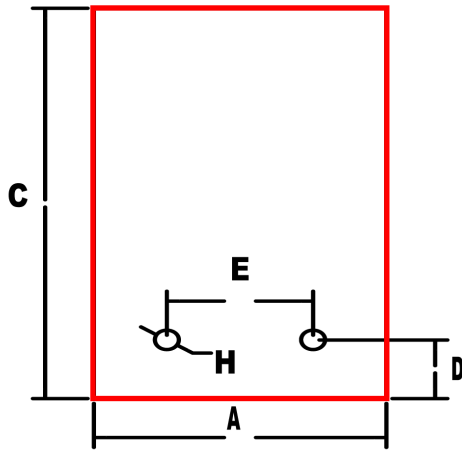

STYLE DKR

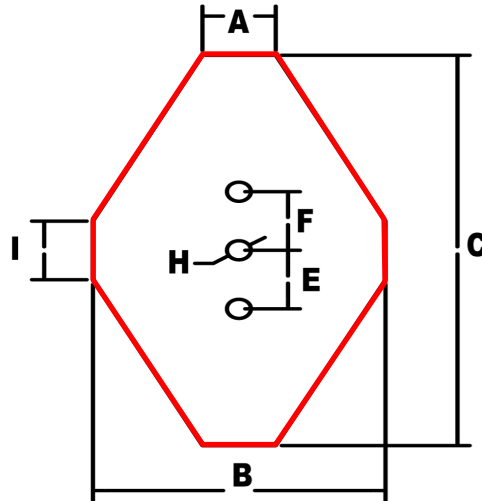

DIKER PADDLE for SUNCO

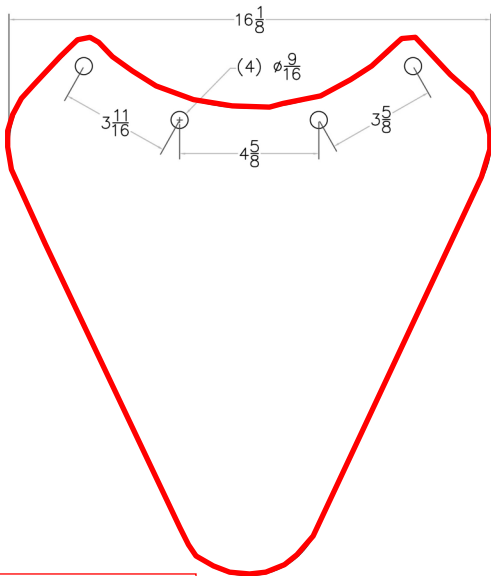

NORWEST
PART #
DKB41618



When Ordering Your Custom Diker Paddle Blades:

Use the table below to obtain correct paddle measurements. Select the desired style, and measure your existing Diker Paddle Blade accordingly. Following these steps will help ensure that the paddle produced for you is the right one.

STYLE	#1-DK	#2-DKB	#3-DKU	#4-DKS	#5-DKR
(A) Tip Width					
(B) Base Width				N/A	
(C) Height					
(D) Base to Hole Center					N/A
(E) Hole Center to Hole Center					
(F) Hole Center to Hole Center	N/A			N/A	
(G) Length of Slot	N/A	N/A		N/A	N/A
(H) Hole Size & Bolt Size					
(I) Side Dimension	N/A	N/A	N/A	N/A	
(J) Material Thickness					

Hilling Wing Assembly

- Available in 2 sizes
- Fits most diker style machines
- Commonly used for Potato applications, but will work for other row crops
- Wings easily adjustable for hill size preferences



Norwest Part #
B-2800L

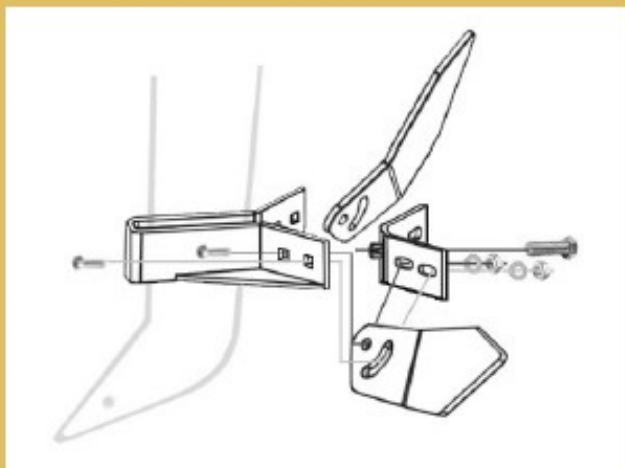

71 South 215 West • Rupert, Idaho 83350
Phone: (208)436-1770 • Fax: (208)436-1776
www.norwest-mfg.com



Norwest Part #
B-2800

Hilling Wing Assembly Sub Parts for B-2800 & B-2800L

PART	NORWEST PART NUMBER	DESCRIPTION
	Z-B-2830	Right Hand Wing for B-2800 & B-2800L Hilling Wing Assemblies
	Z-B-2831	Left Hand Wing for B-2800 & B-2800L Hilling Wing Assemblies
For B-2800 Assembly Only		
	Z-B-2810	Front Strap
	Z-B-2840	Rear Strap
For B-2800L Assembly Only		
	Z-B-2810L	Front Strap
	Z-B-2840L	Rear Strap



NORWEST
MANUFACTURING





NORWEST

MANUFACTURING

71 SOUTH 215 WEST-RUPERT, ID- PHONE: (208) 436-1770 - FAX: (208) 436-1776

REPLACEMENT BLADES FOR NOBLE (V-BLADES; UNDERCUTTER BLADES)

75° Blade

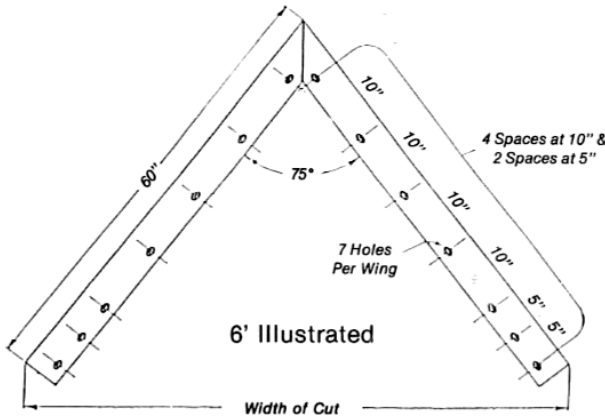

100° Blade

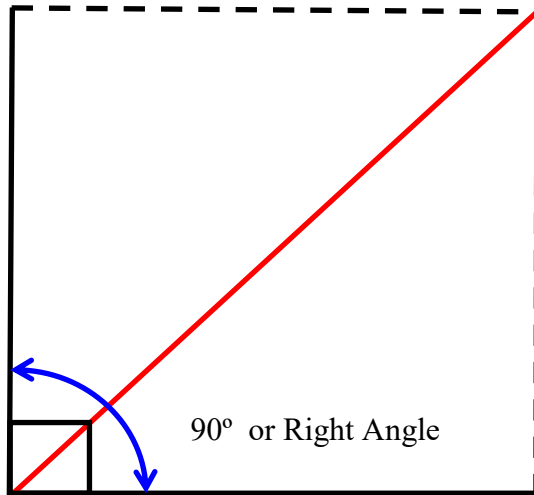
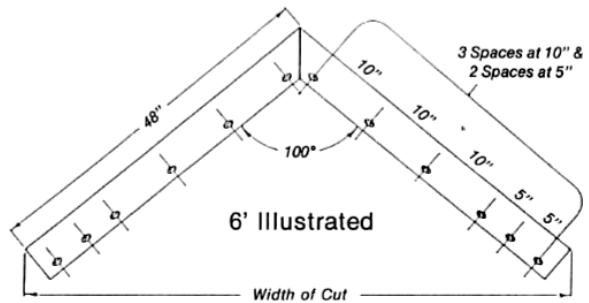

HOW TO TELL IF YOU HAVE A 75° OR A 100° BLADE:

- ◆ TURN YOUR BLADE SO ONE EDGE IS LAYING ON THE GROUND.
- ◆ IF THE BLADE IS LESS THAN A RIGHT ANGLE (90°), YOU WILL NEED A 75° BLADE.
- ◆ IF THE BLADE IS GREATER THAN A RIGHT ANGLE, YOU WILL NEED A 100° BLADE.

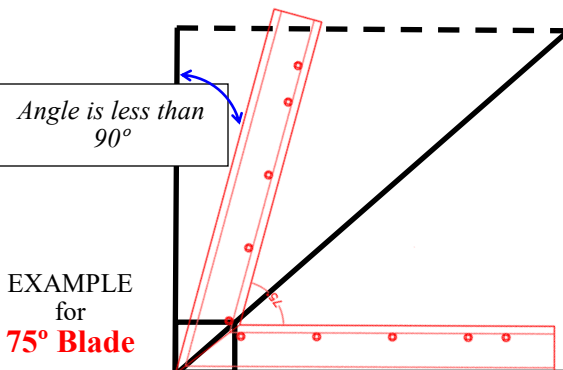

EXAMPLE for
75° Blade

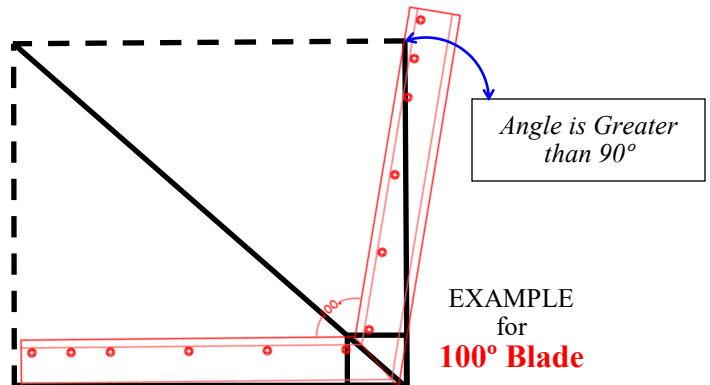

EXAMPLE for
100° Blade



NORWEST

MANUFACTURING

71 SOUTH 215 WEST-RUPERT, ID- PHONE: (208) 436-1770 - FAX: (208) 436-1776



REPLACEMENT BLADES FOR NOBLE (V-BLADES; UNDERCUTTER BLADES)

Norwest offers replacement blades for Noble implements in several sizes and variations.
75° & 100° blade options available.

Blades are available with the following surface options:

Plain = **(P)**, Top Hardfaced = **(T)**, Top Hardfaced with a chrome cap = **(TC)**, or
Bottom Hardfaced = **(B)**, or Bottom Hardfaced with a chrome cap = **(BC)**.



75° Replacement Blades

Width of Cut (Feet)	PART NUMBERS			Blade Wing Length (Inches)	Hole Spacing	# of Holes Per Wing
	Plain Blade (P)	Top Hard Faced Blade (T)	Bottom Hard Faced Blade (B)			
	Norwest Part #					
5	VB75P500	VB75T500	VB75B500	50	(3) 10" - (1) 5"	5
5-1/2	VB75P550	VB75T550	VB75B550	54	(3) 10" - (2) 5"	6
6	VB75P600	VB75T600	VB75B600	60	(4) 10" - (2) 5"	7
6-1/2	--	VB75T650	VB75B650	65	(4) 10" - (3) 5"	8
7	VB75P700	VB75T700	--	69	(4) 10" - (3) 5"	8

100° Replacement Blades

Width of Cut (Feet)	PART NUMBERS			Blade Wing Length (Inches)	Hole Spacing	# of Holes Per Wing
	Plain Blade (P)	Top Hard Faced Blade (T)	Bottom Hard Faced Blade (B)			
	Norwest Part #					
5	VB100P500	VB100T500	--	40	(2) 10" - (2) 5"	5
5-1/2	VB100P550	VB100T550	--	43-1/4	(2) 10" - (3) 5"	6
6	VB100P600	VB100T600	--	48	(3) 10" - (2) 5"	6
8	VB100P800	--	--	62-11/16	(4) 10" - (2) 5"	7

NOT ALL BLADES ARE STOCKED! PLEASE CALL FOR AVAILABILITY.

***OTHER SIZES AVAILABLE UPON REQUEST. PLEASE CALL FOR DETAILS**



NORWEST

MANUFACTURING

71 SOUTH 215 WEST-RUPERT, ID- PHONE: (208) 436-1770 - FAX: (208) 436-1776

REPLACEMENT BLADES FOR HAYBUSTER

Norwest offers replacement blade for Haybuster implements in two styles.

Blades are available with the following surface options:

Plain = (P) & Hardfaced = (H)



NORWEST PART NUMBER	ITEM DESCRIPTION
Z-HAYBUSTER	PLAIN
Z-HAYBUSTERH	HARDACED

REPLACEMENT BLADES FOR CALKINS

Norwest offers replacement blades for Calkins Stubble Choppers.

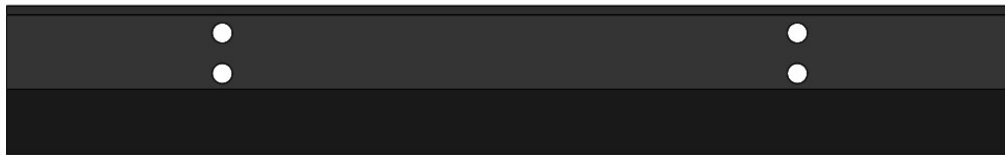

NORWEST PART NUMBER	ITEM DESCRIPTION
Z-CALKINS-2	.375" x 4.125" x 28"

**OTHER VARIATIONS AND BLADE SIZES AVAILABLE. PLEASE CALL FOR DETAILS*